

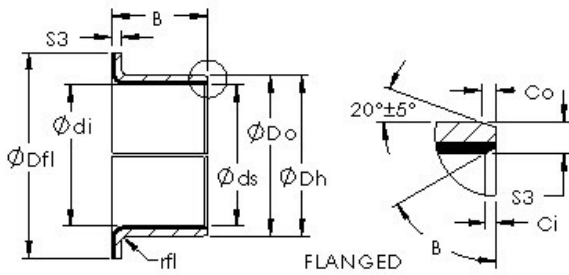

# Bearing equipment manufacturing Co., Ltd



## AST AST40 F22200 plain bearings

Bearing No. AST40 F22200

Bore Diameter	22 mm
Outer Diameter	25 mm
Bearing Type	flanged
Shaft Dia., Nominal (d)	22.0000
Shaft Size (ds) - 22 -0.02 / -0.041	22 0.02 / 0.041
Housing Bore Dia. (Dh)	25 +0.021 / +0
Bearing Outside Diameter, Nominal(Do)	25.000
Bearing Outside Diameter Tolerance (Do tol.)	25.075 / 25.035
Bearing Bore after Mounting (di)	22.071 / 21.99
Average Clearance (Cd)	0.0610
Wall Thickness (S3)	1.505
Bearing Length, Nominal (B)	20.000
Bearing Length Tolerance (B tol.) - +0.25 / -0.25	+0.25 / 0.25
OD Chamfer Length (Co)	0.700
ID Chamfer Angle (B deg.)	30
ID Chamfer Length (Ci)	0.500
Flange Dia. (Dfl pm 0.5)	32.000
Flange Radius (rfl)	1.500
Material	Steel shell with PTFE / Polymer Fiber lining

AST40 F22200 Bearing 2D drawings and 3D CAD models