

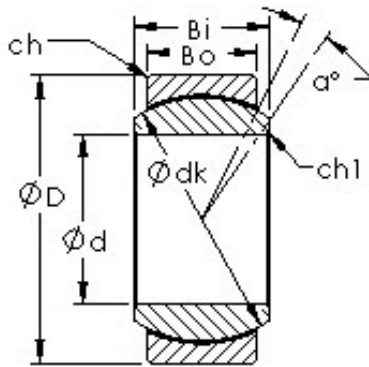

# Bearing equipment manufacturing Co., Ltd



## AST GEFZ25C plain bearings

Bearing No. GEFZ25C

Bore Diameter	25,4 mm
Outer Diameter	44,45 mm
Bearing Type - inch series	standard
Bore Dia (d)	25.4000
Outer Dia (D)	44.4500
Outer Width (Bo)	20.2438
Inner Width (Bi)	25.4000
Dynamic Load Rating (Cr)	502,681
Static Load Rating (Cor)	1,258,926
Max. shaft corner radius, or 45 deg. chamfer (ch1)	0.610
Max. housing corner radius, or 45 deg. chamfer (ch)	1.118
Spherical Diameter (dk or Dk)	38.100
Mis-alignment Angle (a deg.)	10
Weight (g)	173.00
Material - Outer Ring - Carbon steel, Inner ring	52100 Chrome steel, or equivalent

GEFZ25C Bearing 2D drawings and 3D CAD models