

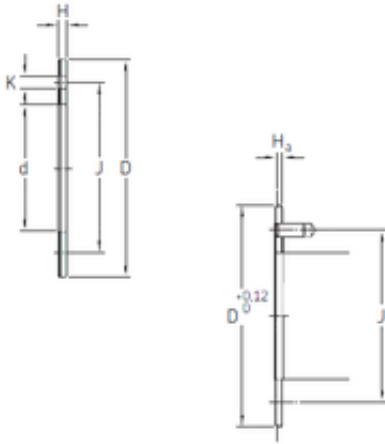

Bearing equipment manufacturing Co., Ltd



SKF PCMW 629002 E plain bearings

Bearing No. PCMW 629002 E

Size	62x90x2 mm
Bore Diameter	62 mm
Outer Diameter	90 mm
Width	2 mm
d	62 mm
D	90 mm
H	2 mm
J	76 mm
K	4,25 mm
Ha min.	1,5 mm
Weight	0,052 Kg
Basic dynamic load rating (C)	265 kN
Category	Bearings
Inventory	0.0
Manufacturer Name	SKF
Minimum Buy Quantity	N/A
UNSPSC	31171515
Weight / Kilogram	0.051
Product Group	B04264
D _a	90 mm
J _a	76 mm
H _a	1.5 mm
Basic dynamic load rating - radial direction C	265 kN
Basic static load rating - radial direction C ₀	830 kN

PCMW 629002 E Bearing 2D drawings and 3D CAD models



Bearing equipment manufacturing Co., Ltd

Specific dynamic load factor K	80 N/mm ²
Specific static load factor K ₀	250 N/mm ²
Factor depending on material and bearing type K _M	300
Permissible sliding velocity v max.	2 m/s
Permissible sliding velocity v min.	0 m/s
Coefficient of friction μ max.	0.25
Coefficient of friction μ min.	0.03
Mass thrust washer	0.052 kg