

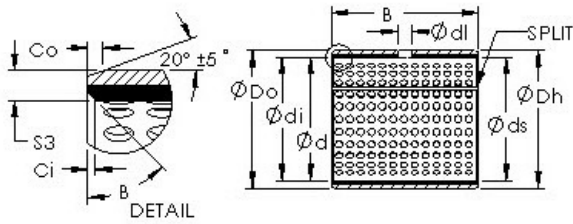

# Bearing equipment manufacturing Co., Ltd



## AST AST20 3020 plain bearings

Bearing No. AST20 3020

|  |   |
|--|---|
| Bore Diameter                                  | 30 mm                                     |
| Outer Diameter                                 | 34 mm                                     |
| Bearing Type                                   | straight                                  |
| Shaft Dia., Nominal (d)                        | 30.0000                                   |
| Shaft Size (ds) - 30 +0 / -0/033               | 30 +0 / 0/033                             |
| Housing Bore Dia. (Dh) - 34 +0.025 / -0        | 34 +0.025 / 0                             |
| Bearing Outside Diameter, Nominal(Do)          | 34.000                                    |
| Bearing Outside Diameter Tolerance (Do tol.)   | 34.085 / 34.045                           |
| Bearing Bore after Mounting (di)               | 30.155 / 30.060                           |
| Average Clearance (Cd)                         | 0.1240                                    |
| Wall Thickness (S3)                            | 1.953                                     |
| Bearing Length, Nominal (B)                    | 20.000                                    |
| Bearing Length Tolerance (B tol.) - +0 / -0.40 | +0 / 0.40                                 |
| OD Chamfer Length (Co)                         | 1.200                                     |
| ID Chamfer Angle (B deg.)                      | 30  |
| ID Chamfer Length (Ci)                         | 0.500                                     |
| Lube Hole Dia. (dl)                            | 6.000                                     |
| Material                                       | Carbon steel shell with POM plastic liner |

AST20 3020 Bearing 2D drawings and 3D CAD models