

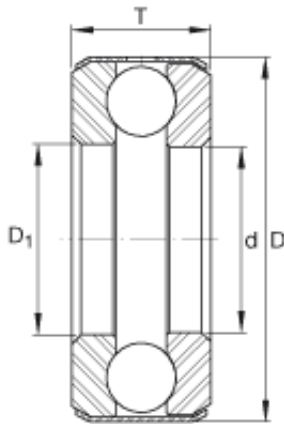

Bearing equipment manufacturing Co., Ltd



B14 Bearing 2D drawings and 3D CAD models

INA B14 thrust ball bearings

Bearing No. B14

Size	33.338x59.54x19.05 mm
Bore Diameter	33,338 mm
Outer Diameter	59,54 mm
Width	19,05 mm
d	1 5/16 inch
d	33,338 mm
D	2,344 inch
D	59,54 mm
T	0,75 inch
T	19,05 mm
D ₁	1,354 inch
m	0,481 lbs / Weight
m	0,218 kg / Weight
C _a	9300 lbf / Dynamic load rating (axial)
C _a	41400 N / Dynamic load rating (axial)
C _{0a}	18800 lbf / Static load rating (axial)
C _{0a}	84000 N / Static load rating (axial)
Category	Thrust Ball Bearing
Inventory	0.0
Manufacturer Name	SCHAEFFLER GROUP
Minimum Buy Quantity	N/A
Weight / Kilogram	0.22
EAN	4054364115494



Bearing equipment manufacturing Co., Ltd

Product Group	B00308
Rolling Element	Ball Bearing
Thrust Bearing	Yes
Single or Double Direction	Single Direction
Banded	Yes
Precision Class	ABEC 1 ISO P0
Component Description	Roller Assembly Plus Raceways
Other Features	Single Row Deep Groove Medium Cross Section Grooved Race Non Separable Full Complement Standard Oil Hole in Band
Long Description	1-5/16" Bore 1; 1.354" Bore 2; 2-11/32" Outside Diameter; 3/4" Height; Ball Bearing; Single Direction; Banded; ABEC 1 ISO P0 Precision
Inch - Metric	Inch
Category	Thrust Ball Bearings
UNSPSC	31171507
Harmonized Tariff Code	8482.10.50.08
Noun	Bearing
Keyword String	Ball Thrust
Manufacturer URL	http://www.ina.com
Manufacturer Item Number	B14
Weight / LBS	0.481
Overall Height with Aligning Washer	0 Inch 0 Millimeter
Bore 1	1.313 Inch 33.35 Millimeter
Bore 2	1.354 Inch 34.392 Millimeter
Outside Diameter	2.344 Inch 59.538 Millimeter



Bearing equipment manufacturing Co., Ltd

Height	0.75 Inch 19.05 Millimeter
--------	------------------------------