

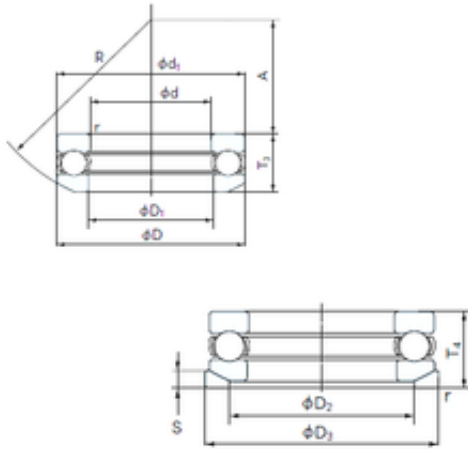

Bearing equipment manufacturing Co., Ltd

NACHI 53218U thrust ball bearings

Bearing No. 53218U



53218U Bearing 2D drawings and 3D CAD models

Size	90x135x42 mm
Bore Diameter	90 mm
Outer Diameter	135 mm
Width	42 mm
d	90 mm
D	135 mm
T	42 mm
d1	135 mm
r min.	1.1 mm
A	45 mm
D1	93 mm
D2	110 mm
D3	140 mm
R	100 mm
S	13.5 mm
Weight	2.22 Kg
Basic dynamic load rating (C)	116 kN
Basic static load rating (C0)	325 kN
(Grease) Lubrication Speed	1400 r/min