

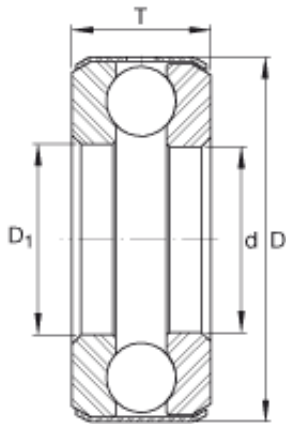

## Bearing equipment manufacturing Co., Ltd



### INA D13 thrust ball bearings

Bearing No. D13

Size	31.75x59.538x15.875 mm
Bore Diameter	31,75 mm
Outer Diameter	59,538 mm
Width	15,875 mm
d	1 1/4 inch
d	31,75 mm
D	2,344 inch
D	59,538 mm
T	0,625 inch
T	15,875 mm
D <sub>1</sub>	1,281 inch
m	0,4 lbs / Weight
m	181 g / Weight
C <sub>a</sub>	7200 lbf / Dynamic load rating (axial)
C <sub>a</sub>	32000 N / Dynamic load rating (axial)
C <sub>0a</sub>	15700 lbf / Static load rating (axial)
C <sub>0a</sub>	70000 N / Static load rating (axial)
Category	Thrust Ball Bearing
Inventory	14.0
Manufacturer Name	SCHAEFFLER GROUP
Minimum Buy Quantity	N/A
Weight / Kilogram	0.18
EAN	4012802034417

D13 Bearing 2D drawings and 3D CAD models



## Bearing equipment manufacturing Co., Ltd

Product Group	B00308
Rolling Element	Ball Bearing
Thrust Bearing	Yes
Single or Double Direction	Single Direction
Banded	Yes
Precision Class	ABEC 1   ISO P0
Component Description	Roller Assembly Plus Raceways
Other Features	Single Row   Deep Groove   Medium Cross Section   Grooved Race   Non Separable   Full Complement   Standard Oil Hole in Band
Long Description	1-1/4" Bore 1; 1-9/32" Bore 2; 2-11/32" Outside Diameter; 5/8" Height; Ball Bearing; Single Direction; Banded; ABEC 1   ISO P0 Precision
Inch - Metric	Inch
Category	Thrust Ball Bearings
UNSPSC	31171507
Harmonized Tariff Code	8482.10.50.08
Noun	Bearing
Keyword String	Ball Thrust
Manufacturer URL	<a href="http://www.ina.com">http://www.ina.com</a>
Manufacturer Item Number	D13
Weight / LBS	0.4
Bore 1	1.25 Inch   31.75 Millimeter
Outside Diameter	2.344 Inch   59.538 Millimeter
Overall Height with Aligning Washer	0 Inch   0 Millimeter
Height	0.625 Inch   15.875 Millimeter



## Bearing equipment manufacturing Co., Ltd

Bore 2

1.281 Inch | 32.537  
Millimeter