

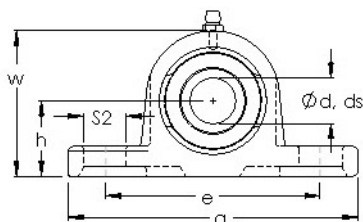

Bearing equipment manufacturing Co., Ltd

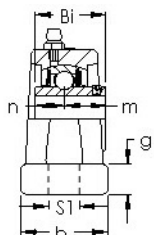

AST UCP 215 bearing units

Bearing No. UCP 215

Bore Diameter	75 mm
Bearing Type	Extended inner race with set screws
Dynamic Load Rating (Cr)	67,453
Static Load Rating (Cor)	48,240
Shaft Dia. (Fw)	75.0000
Shaft Height (h)	82.6000
Housing Width (b)	74.0000
Mounting Hole Center-to-Center (e)	217.0000
Housing Length (a)	275.0000
Mounting Slot Length (S2)	30.0000
Mounting Slot Width (S1)	25.0000
Housing Base Thickness (g)	28.0000
Housing Height (w)	162.0000
Bearing Inner Race Width (Bi)	77.8000
Bearing Inner Race Width - Short Side (n)	33.3000
Bearing Inner Race Width - Extended Side (m)	44.5000
Mounting Bolt Size	20.0000
Housing Number	P 215
Shaft Dia., Nominal (d)	75.0000
Weight (g)	7,303.00
Material	Cast iron housing, chrome steel bearing

UCP 215 Bearing 2D drawings and 3D CAD models