

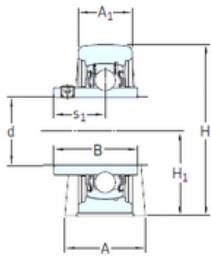

Bearing equipment manufacturing Co., Ltd

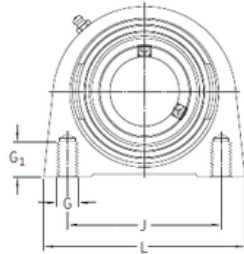

SYF



SKF SYF 40 FM bearing units

Bearing No. SYF 40 FM

Bore Diameter	40 mm
d	40 mm
s1	32,7 mm
A	48 mm
A1	30 mm
B	43,7 mm
G1	20 mm
H	99 mm
H1	49,2 mm
J	88,9 mm
L	116 mm
Thread (G)	M 12
Weight	1,5 Kg
Basic dynamic load rating (C)	30,7 kN
Basic static load rating (C0)	19 kN
Fatigue load limit (Pu)	0,8
Category	Pillow Block Bearings
Inventory	0.0
Manufacturer Name	SKF
Minimum Buy Quantity	N/A
Weight / Kilogram	1.747
EAN	7316570416299
Product Group	M06110
Number of Mounting Holes	2
Mounting Method	Eccentric Collar
Housing Style	2 Bolt Tap Base Pillow Block

SYF 40 FM Bearing 2D drawings and 3D CAD models



Bearing equipment manufacturing Co., Ltd

Rolling Element	Ball Bearing
Housing Material	Cast Iron
Expansion / Non-expansion	Non-expansion
Mounting Bolts	12 Millimeter
Relubricatable	Yes
Insert Part Number	YET 208
Seals	M Seal
Housing Configuration	1 Piece Solid
Inch - Metric	Metric
Other Features	Single Row Narrow Inner Race Short Base Y Bearing
Long Description	2 Bolt Tap Base Pillow Block; 40MM Bore; 49.2MM Base to Center Height; Eccentric Collar Mount; Ball Bearing; Relubricatable; Cast Iron; M Seal; Non-expansion
Category	Pillow Block
UNSPSC	31171511
Harmonized Tariff Code	8483.20.40.40
Noun	Bearing
Keyword String	Pillow Block
Manufacturer URL	http://www.skf.com
Manufacturer Item Number	SYF 40 FM
Weight / LBS	3.42
Bolt Spacing Maximum	0 Inch 0Millimeter
Bolt Spacing Minimum	0 Inch 0Millimeter
Bore	1.575 Inch 40 Millimeter
Nominal Bolt Center to Center	3.5 Inch 90 Millimeter
Actual Bolt Center to Center	3.5 Inch 90Millimeter
Base to Center Height	1.937 Inch 49.2 Millimeter



Bearing equipment manufacturing Co., Ltd

Length Thru Bore	1.72 Inch 43.7 Millimeter
Housing material	Cast iron
A ₁	30 mm
B ₁	43.7 mm
H ₁	49.2 mm
s ₁	33.2 mm
R _G	1/4-28 UNF
R ₁	3.5 mm
R	45 °
D _N	6.5 mm
SW _N	7 mm
G _N	1/4-28 SAE-LT
Basic dynamic load rating C	30.7 kN
Basic static load rating C ₀	19 kN
Fatigue load limit P _u	0.8 kN
Limiting speed	4800 r/min
Mass bearing unit	1.65 kg
Housing thread for attachment bolts G	M12
Thread length G ₁	20 mm
Thread grub screw G ₂	M10x1
Hexagonal key size for grub screw N	5 mm
Recommended tightening torque for grub screw	16.5 N · m
Housing	SYF 508
Bearing	YET 208